

# Lyra

## WITH STANDARD BOX BASE

- The sides of the base are secured to the head- and footend with bench screws. Position the stabilisers in a way that supports all of the base boards equally.

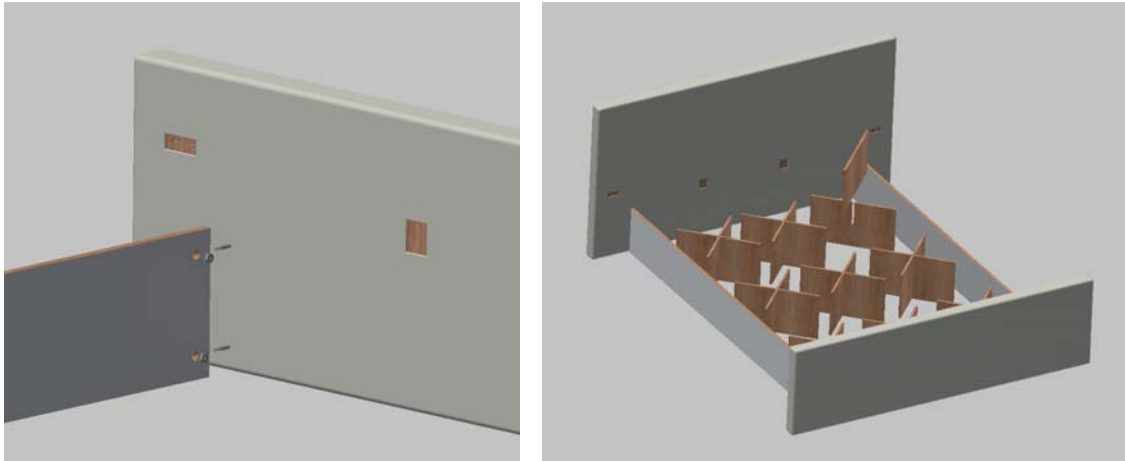

## WITH DRAWER BASE

- When assembling the drawers: see separate instructions (e.g. Big, Box, drawers on castors, storage base).
- Fit a middle piece at head- and footend with bench screws.
- Cover with a deck plate (to be fastened on the middle piece from the inside with screws).

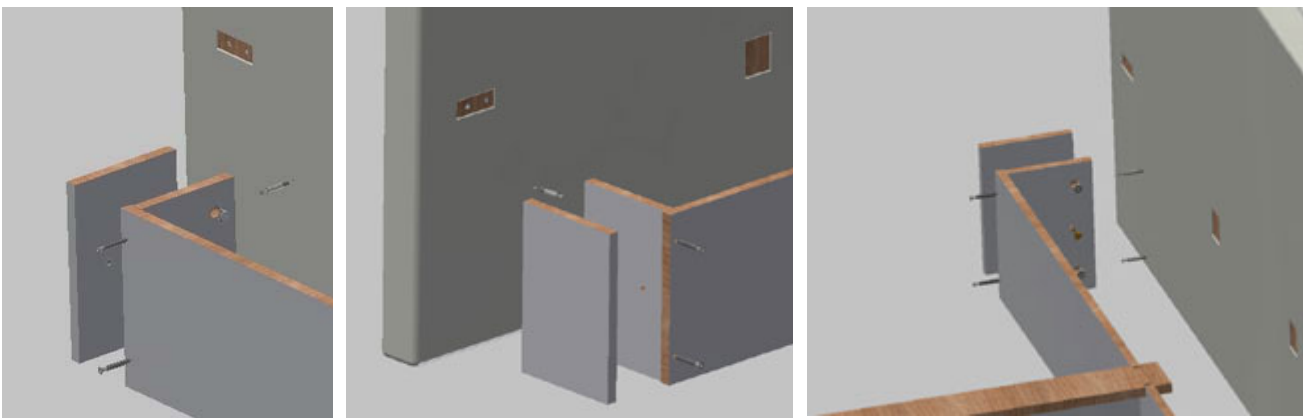

## FITTING FROM THE BASE AND UPWARDS

- Place the base boards plates on the base frame connect them with the four black legs. Secure with the fixing paddles.
- The upholstered sides of the frame are connected loosely with the head- and footend parts by means of angle brackets. Begin with the inner screws.
- When the base boards and upholstered sides have been placed symmetrically, the screws are fastened tightly one by one.



- Now fasten 2 more angle brackets per side to the side parts and the base boards.

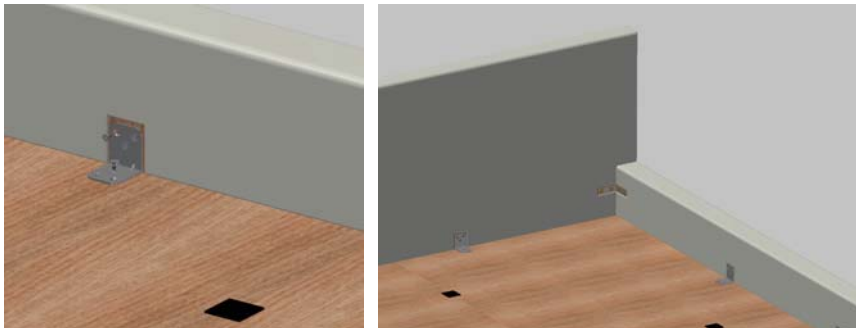

- When installing the rest of the bed: see instructions for HARDSIDE.